

# SONOFF

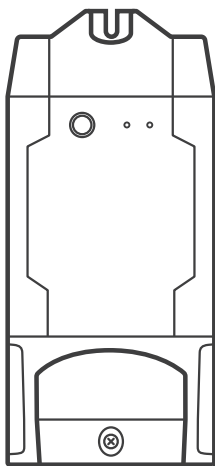

## DIY DUALR2

User manual V1.0



## 2-Gang Wi-Fi Smart Switch

---

# Operating Instruction

## 1. Power off

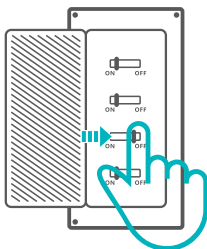

⚠ To avoid electric shocks, please consult the dealer or a qualified professional for help when installing and repairing!

## 2. Wiring instruction

Light fixture wiring instruction:

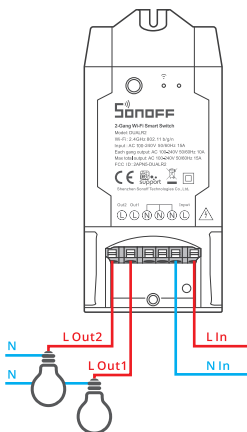

Appliance wiring instruction:

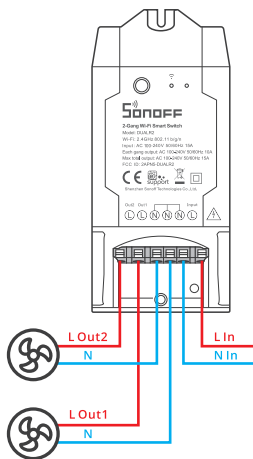

⚠ Make sure the neutral wire and live wire connection is correct.

## 3. Download APP

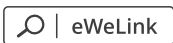

Android™ &amp; iOS

## 4. Power on



After powering on, the device will enter the quick pairing mode (Touch) during the first use. The Wi-Fi LED indicator changes in a cycle of two short and one long flash and release.

⚠ The device will exit the quick pairing mode (Touch) if not paired within 3mins. If you want to enter this mode, please long press the manual button for about 5s until the Wi-Fi LED indicator changes in a cycle of two short and one long flash and release.

## 5. Add the device

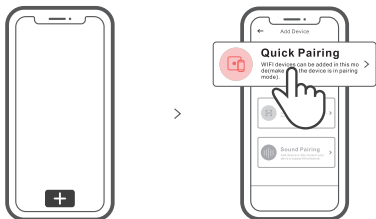

Tap "+" and select "Quick Pairing", then operate following the prompt on the APP.

## Compatible Pairing Mode

If you fail to enter Quick Pairing Mode (Touch), please try "Compatible Pairing Mode" to pair.

- ① Long press Pairing button for 5s until the Wi-Fi LED indicator changes in a cycle of two short flashes and one long flash and release. Long press Pairing button for 5s again until the Wi-Fi LED indicator flashes quickly. Then, the device enters Compatible Pairing Mode.
- ② Tap "+" and select "Compatible Pairing Mode" on APP.

Select Wi-Fi SSID with ITEAD-\*\*\*\*\* and enter the password 12345678, and then go back to eWeLink APP and tap "Next". Be patient until pairing completes.

## Specifications

|                     |                                |
|---------------------|--------------------------------|
| Model               | DUALR2                         |
| Input               | 100-240V AC 50/60Hz            |
| Output              | 100-240V AC 50/60Hz            |
| Max.Load            | 10A/2200W/Gang 15A/3500W/Total |
| Wi-Fi               | IEEE 802.11 b/g/n 2.4GHz       |
| Operating systems   | Android & iOS                  |
| Number of Gangs     | 2                              |
| Working temperature | -10°C~40°C                     |
| Material            | PC V0                          |
| Dimension           | 114.5x52x32mm                  |

## Product Introduction

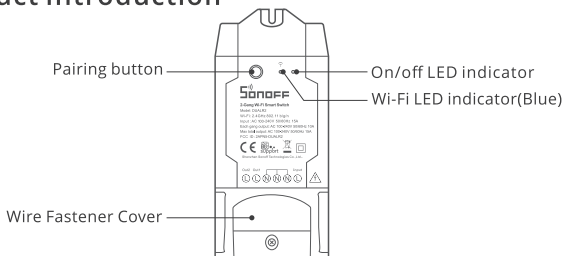

- ⚠ The device weight is less than 1 kg.  
 The installation height of less than 2 m is recommended.

## Wi-Fi LED indicator status instruction

| Wi-Fi LED indicator status       | Status instruction                                 |
|----------------------------------|--|
| Flashes (one long and two short) | Quick Pairing Mode                                 |
| Keeps on                         | Device is connected successfully                   |
| Flashes quickly                  | Compatible Pairing Mode                            |
| Flashes quickly once             | Unable to discover the router                      |
| Flashes quickly twice            | Connect to the router but fail to connect to Wi-Fi |
| Flashes quickly three times      | Upgrading  |

## Features

This device is a 2-gang Wi-Fi smart switch that allows you to remotely turn on/off the device, schedule it on/off or share it with your family to control together.



Remote Control



Single/Countdown  
Timing



Voice Control



Share Control



Smart Scene



Interlock



Inching Mode



Camera Linking



Power-on State



LAN Control

## Switch Network

If you need to change the network, long press the pairing button for 5s until the Wi-Fi LED indicator changes in a cycle of two short and one long flash and release, then the device enters quick pairing mode and you can pair again.



## Factory Reset

Deleting the device on the eWeLink app indicates you restore it to factory setting.

## Common Problems

Q: Why my device stays "Offline"?

A: The newly added device needs 1 – 2mins to connect Wi-Fi and network. If it stays offline for a long time, please judge these problems by the blue Wi-Fi indicator status:

1. The blue Wi-Fi indicator quickly flashes once per second, which means that the switch failed to connect your Wi-Fi:
  - ① Maybe you have entered a wrong Wi-Fi password.
  - ② Maybe there's too much distance between the switch your router or the environment causes interference, consider getting close to the router. If failed, please add it again.
  - ③ The 5G Wi-Fi network is not supported and only supports the 2.4GHz wireless network.
  - ④ Maybe the MAC address filtering is open. Please turn it off.

**If none of the above methods solved the problem, you can open the mobile datanetwork on your phone to create a Wi-Fi hotspot, then add the device again.**

2. Blue indicator quickly flashes twice per second, which means your device has connected to Wi-Fi but failed to connect to the server.

Ensure steady enough network. If double flash occurs frequently, which means you access an unsteady network, not a product problem. If thenetwork is normal, try to turn off the power to restart the switch.

## FCC Warning

Changes or modifications not expressly approved by the party responsible for compliance could avoid the user's authority to operate the equipment.

This device complies with part 15 of the FCC Rules. Operation is subject to the following two conditions: (1) This device may not cause harmful interference, and (2) this device must accept any interference received, including interference that may cause undesired operation.

### **FCC Radiation Exposure Statement:**

This equipment complies with FCC radiation exposure limits set forth for an uncontrolled environment. This equipment should be installed and operated with minimum distance 20cm between the radiator & your body. This transmitter must not be co-located or operating in conjunction with any other antenna or transmitter.

### **Note:**

This equipment has been tested and found to comply with the limits for a Class B digital device, pursuant to part 15 of the FCC Rules. These limits are designed to provide reasonable protection against harmful interference in a residential installation. This equipment generates, uses and can radiate radio frequency energy and, if not installed and used in accordance with the instructions, may cause harmful interference to radio communications. However, there is no guarantee that interference will not occur in a particular installation. If this equipment does cause harmful interference to radio or television reception, which can be determined by turning the equipment off and on, the user is encouraged to try to correct the interference by one or more of the following measures:

- Reorient or relocate the receiving antenna.
- Increase the separation between the equipment and receiver.
- Connect the equipment into an outlet on a circuit different from that to which the receiver is connected.
- Consult the dealer or an experienced radio/TV technician for help.

Hereby, Shenzhen Sonoff Technologies Co., Ltd. declares that the radio equipment type DUALR2 is in compliance with Directive 2014/53/EU. The full text of the EU declaration of conformity is available at the following internet address:

<https://sonoff.tech/usermanuals>

Australian Certification : ESV180440

Rated Voltage: 240V~  
Rated Current: 16A Rated  
Frequency: 50Hz  
Construction:  $\mu$  Copper  
Length: 10mm  
Manufacturer: Itead  
Distributed by: Oikotec

The logo features the word "SONOFF" in a bold, black, sans-serif font. Above the letter "O" are three curved lines representing radio signal waves.

**Shenzhen Sonoff Technologies Co., Ltd.**

1001, BLDG8, Lianhua Industrial Park, shenzhen, GD, China  
ZIP code: 518000 Website: [sonoff.tech](https://sonoff.tech)

MADE IN CHINA

